

Features

- ESD protection for high speed data lines to IEC61000-4-2
- ESD contact discharge typical 8KV, max 15KV
- ESD air discharge typical 15KV, max 25KV
- Multilayer structure
- Surface mount
- Extremely low capacitance
- Very low leakage current
- Fast response time
- Bi-directional ESD protection
- Lead free solder termination
- The best ESD protection for high frequency, low voltage applications

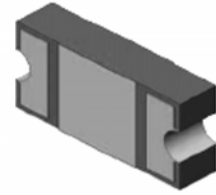

DFN1608

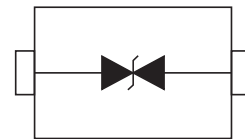

Schematic Diagram

Applications

- High definition multi-media interface (HDMI)
- Digital visual interface (DVI)
- Display port interface (DP)
- Unified display interface (UDI)
- Mobile display digital interface (MDDI)
- Gigabit ethernet
- USB2.0 and USB3.0
- IEEE1394 interface

Absolute Maximum Ratings

Parameter	Symbol	Value	Unit
Maximum Contact Discharge Voltage Per IEC61000-4-2	-	15KV	V
Maximum Air Discharge Voltage Per IEC61000-4-2	-	25KV	V
Maximum Operating Temperature	T _{OPER}	-55 to +125	°C
Maximum Storage Temperature	T _{STG}	-55 to +125	°C
Maximum Lead Temperature for Soldering During 10s	T _L	260	°C

Electrical Characteristics (T_A=25°C unless otherwise specified)

Parameter	Symbol	Test Conditions	Min	Typ	Max	Units
Rated Voltage	V _R	-	-	-	30	V
Trigger Voltage	V _T	IEC61000-4-2 8KV Contact Discharge	-	300	-	V
Clamping Voltage	V _C	IEC61000-4-2 8KV Contact Discharge	-	35	-	V
Leakage Current	I _L	DC 30V Shall be Applied on Component	-	0.01	0.1	μA
Capacitance	C _P	V _R =0V, F=1MHz	-	0.05	-	pF

Note:

1. Trigger and clamping voltage are measured per IEC 61000-4-2, 8KV contact discharge method.
2. After reliability tests such as high temperature storage, temperature cycles, continuous ESD strike etc, the maximum leakage current is less than 10uA.

ESD Clamping Test Waveforms

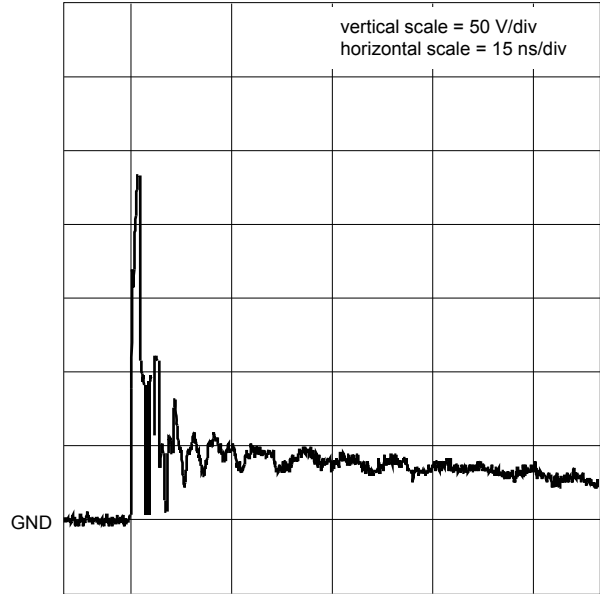
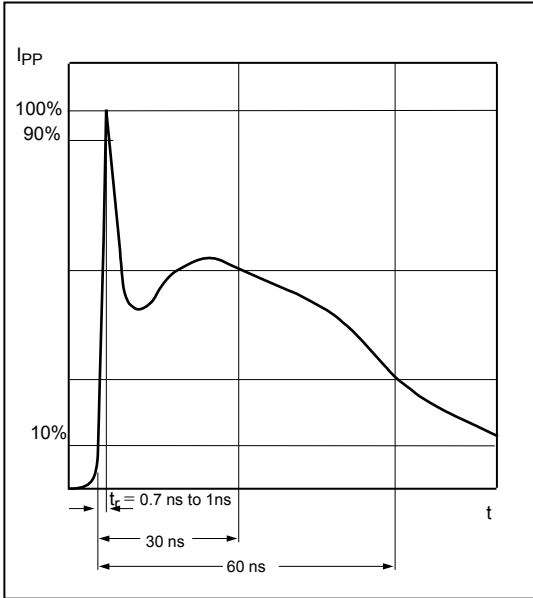

Package Outline Dimensions (DFN1608)

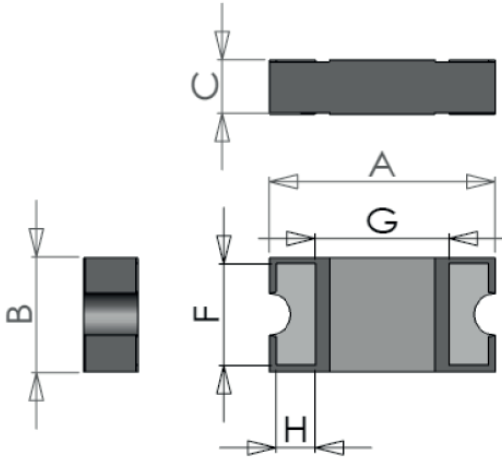

Symbol	Dimensions In Millimeters		Dimensions In Inches	
	Min.	Max.	Min.	Max.
A	1.500	1.700	0.059	0.067
B	0.740	0.900	0.029	0.035
C	0.320	0.400	0.013	0.016
H	0.265	0.305	0.010	0.012
F	0.700	0.740	0.028	0.029
G	0.930	0.970	0.037	0.038

Recommended Pad Layout

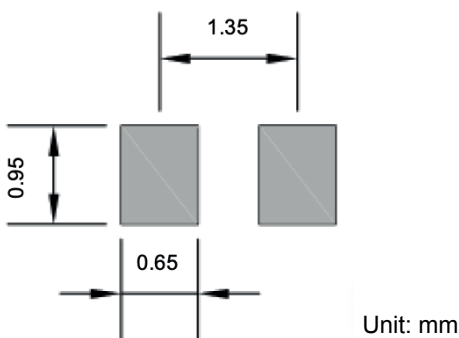

Order Information

Device	Package	Carrier	Quantity	HSF Status
MLSEP30A-0603	DFN1608	Tape & Reel	5,000pcs / Reel	RoHS compliant