

Features

- Plastic package has underwriters Laboratory Flammability Classification 94V-0
- Dual rectifier construction, positive center tap
- Low forward voltage, high efficiency Guarding for over voltage protection
- Component in accordance to RoHS 2015/863/EU

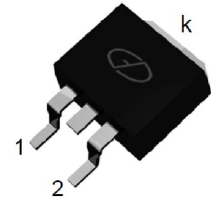

Package: TO-263

Mechanical Data

- Case: epoxy, molded
- Weight: 1.4grams (approximately)
- Lead temperature for soldering purpose: 260°C/10 sec Max

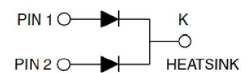

Schematic Diagram

Maximum Ratings & Electrical Characteristics (T_A=25°C unless otherwise noted)

Parameter	Symbol	Test Conditions	Value	Unit
Maximum Repetitive Peak Reverse Voltage	V _{RRM}	-	200	V
Working Peak Reverse Voltage	V _{RWM}	-	200	V
Maximum DC Blocking Voltage	V _{DC}	-	200	V
Maximum Average Forward Rectified Current @T _C =105°C	I _{F(AV)}	Total Device Per Diode	20 10	A
Peak Forward Surge Current 8.3ms Single Half Sine-wave Superimposed on Rated Load per Diode	I _{FSM}	-	200	A
Peak repetitive Reverse Current Per Leg at tp=2.0μs ,1KHz	I _{RRM}	-	1.0	A
Voltage Rate of Change (rated V _R)	dv/dt	-	10000	V/μs
Operating Junction Temperature Range	T _J	-	- 55 to+150	°C
Storage Temperature Range	T _{STG}	-	- 55 to+150	°C
Maximum Instantaneous Forward Voltage per Leg, I _F =10A ¹	V _F	T _A =25°C T _A =125°C	0.92 0.82	V
Maximum Reverse Current per Leg at Working Peak Reverse Voltage ¹	I _R	T _A =25°C T _A =125°C	50 15	μA mA

Note 1.Pulse test:300us pulse width, duty cycle=2%

Thermal Characteristics (T_A=25°C unless otherwise noted)

Parameter	Symbol	Typical	Unit
Thermal Resistance, Junction to Case, per Leg	R _{θJC}	2.0	°C/W
Thermal Resistance, Junction to Ambient, per Leg	R _{θJA}	62.5	°C/W

Ratings and Characteristics Curves ($T_A = 25^\circ\text{C}$ unless otherwise noted)

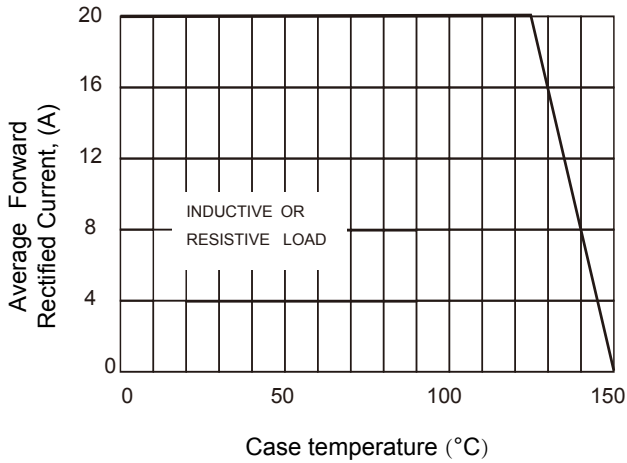

Figure 1. Forward Current Derating Curve

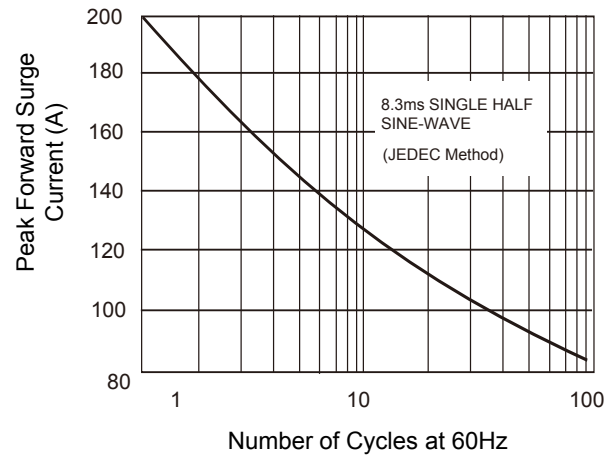

Figure 2. Maximum Non-Repetitive Peak Forward Surge Current

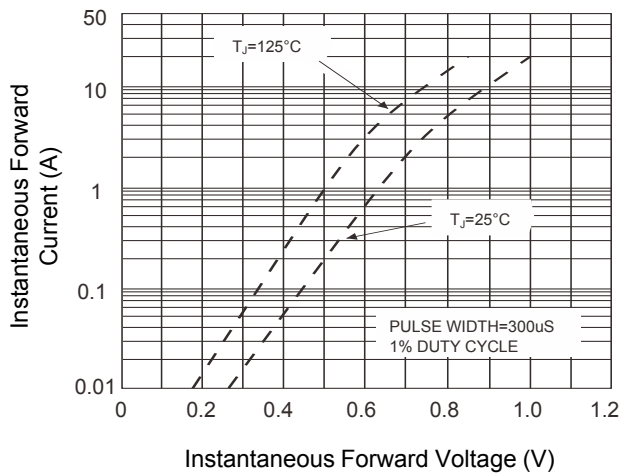

Figure 3. Typical Instantaneous Forward Characteristics

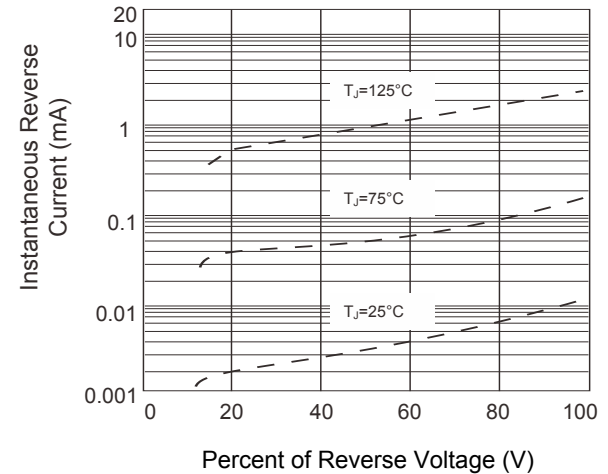
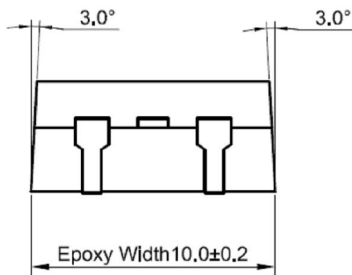
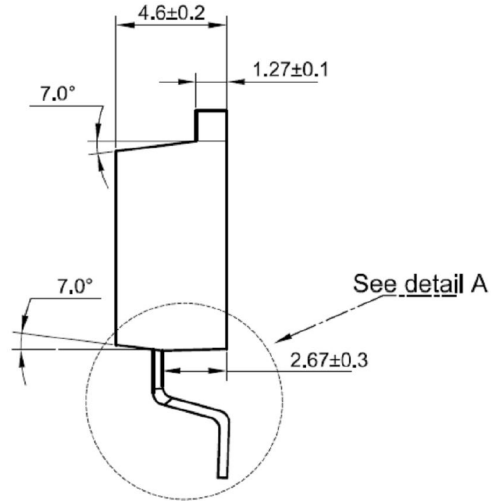
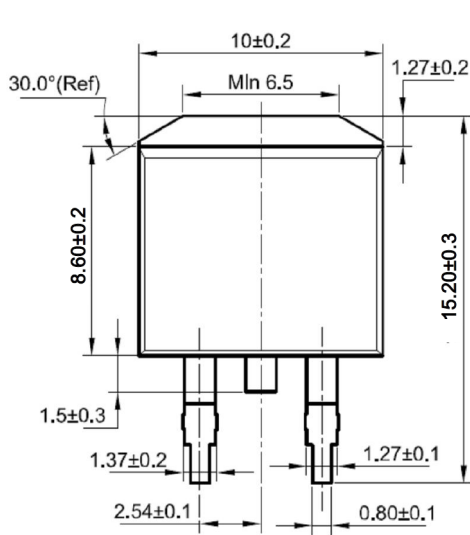

Figure 4. Typical Reverse Characteristics

Package Outline Dimensions TO-263



Detail A

